

SM5002

Heavy-Duty Height-Adjustable Monitor Stand Set

SM5002 Product Overview

EN

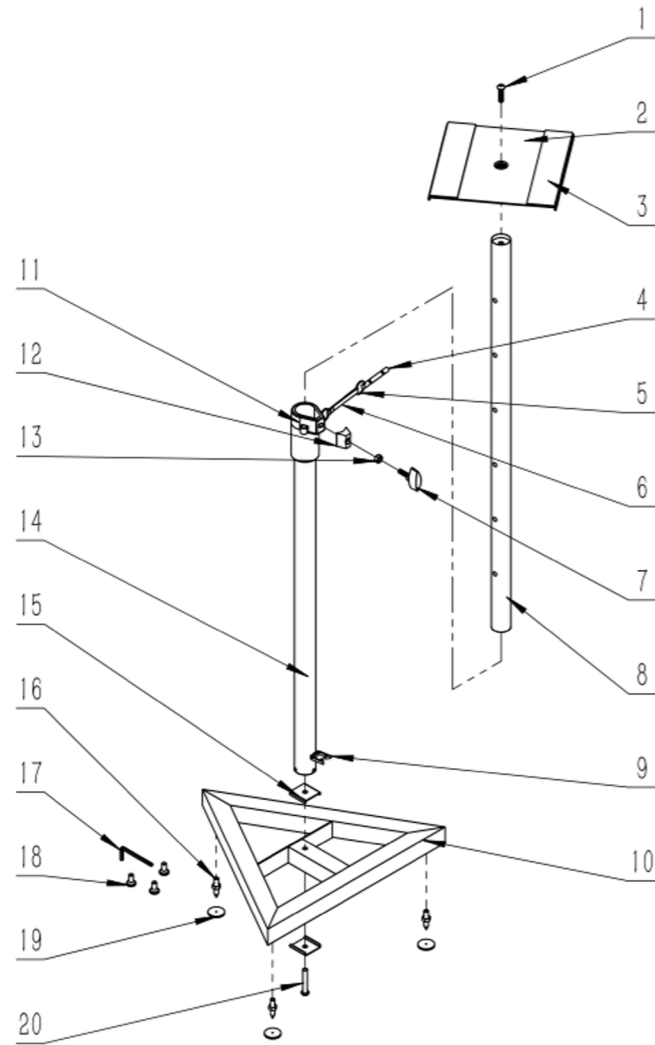

Part No.	Part Name	Qty (pcs)
1	Hexagon socket flat head screws	1
2	tray	1
3	EVA pad	2
4	plug	1
5	key ring	2
6	Cloth bag	1
7	Flat knob M8x25	1
8	Center tube assembly	1
9	Wire clamp	1
10	Triangle base	1

Part No.	Part Name	Qty (pcs)
11	Shrink sleeve 38-35	1
12	Press block R17.5	1
13	Type 1 hex nut	4
14	Supervisor component	1
15	U-shaped card board	2
16	Pointed screw	3
17	Internal six wrenches S5	1
18	Foot pad M8	3
19	Foot gasket	3
20	Hexagon socket flat head screws	1

For near-field monitors

Panel surface: 23 x 23 cm

Height adjustable over several steps from 93 - 158 cm

Maximum load: 45 kg

Length of triangular base: 45 cm per side

Weight: 7.9 kg per stand

Set of 2 in a box

Features

- Universal triangular base stand for studio near field monitors and wide range of loudspeakers
- Perfect for recording studios and listening environments
- Large (23cmX23cm) sturdy metal platform with soft rubberized padding reduces vibration
- Precise height adjustment in 3 steps from 0.93m up to 1.58m of elevation
- Heavy-duty steel construction for maximum weight capacity of 45Kg
- Floor triangular base length of 45cm per side

Package contents

- 1pc speaker bracket tray
- 1ps main tube component
- 1pc triangular base
- 1pc accessory bag
- 1pc instruction manual

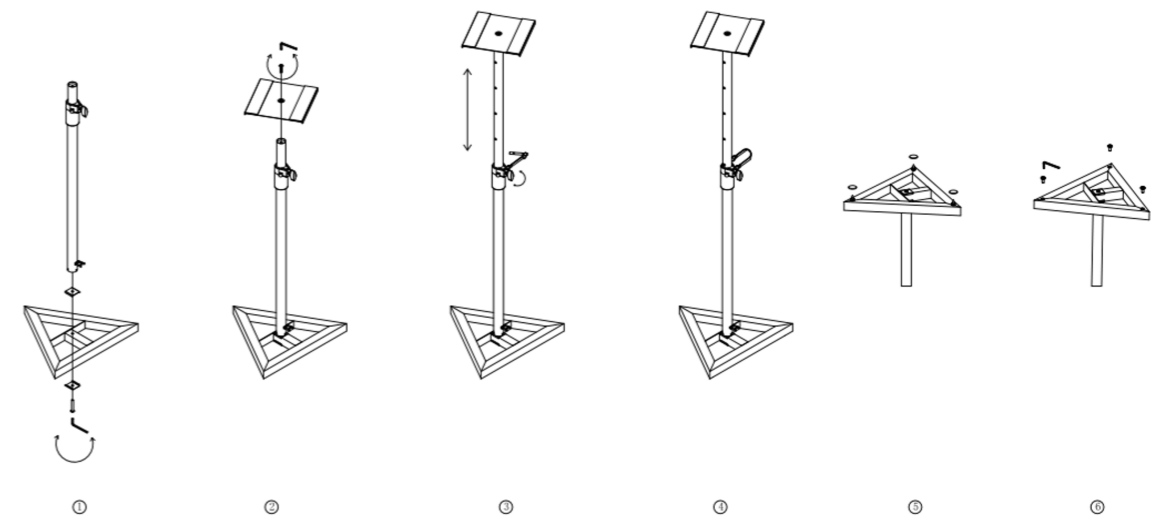

Note:

This device is used to set up and align speaker boxes. Any other use or use under other operating conditions is considered to be improper and may result in personal injury or property damage. No liability will be assumed for damages resulting from improper use.

⚠ DANGER! DANGER for children

Ensure that plastics bags, etc. are properly disposed of and are not in the reach of babies and young children. Choking hazard! Ensure that children do not detach any small parts from the product. They could swallow the pieces and choke! Never let children use electrical devices.

⚠ CAUTION! Danger of tipping when transported under load

If the monitor stand is moved without having removed the speaker box, the stand may tip over and cause injuries and property damage. Remove the installed device before transporting the stand.

⚠ CAUTION! Danger of tipping on unsuitable surfaces

When the monitor stand is installed on soft or uneven ground, the stand may tip over and cause injuries and property damage. Install the stand only on even and solid surfaces.

⚠ CAUTION! Danger of tipping due to overload

In case of overload, the monitor stand may tip over and cause injuries and property damage. Never exceed the maximum load capacity specified for the stand.

For the transport and protective packaging, environmentally friendly materials have been chosen that can be supplied to normal recycling. Ensure the plastic bags, packaging, etc. are properly disposed of. Do not just dispose of these materials with your normal household waste, but make sure that they are collected for recycling. Please follow the notes and markings on the packaging.

LEGAL DISCLAIMER

Music Tribe accepts no liability for any loss which may be suffered by any person who relies either wholly or in part upon any description, photograph, or statement contained herein. Technical specifications, appearances and other information are subject to change without notice. All trademarks are the property of their respective owners. Midas, Klark Teknik, Lab Gruppen, Lake, Tannoy, Turbosound, TC Electronic, TC Helicon, Behringer, Bugera, Aston Microphones and Coolaudio are trademarks or registered trademarks of Music Tribe Global Brands Ltd. © Music Tribe Global Brands Ltd. 2024 All rights reserved.

LIMITED WARRANTY

For the applicable warranty terms and conditions and additional information regarding Music Tribe's Limited Warranty, please see complete details online at community.musictribe.com/support.

We Hear You